

Minimising Efflorescence or Vanadium in newly built brickwork.

Recommended methods for removing Efflorescence and Vanadium can be found in Ibstocks **Technical Information Sheets** 2 and 4. This information sheet concentrates on minimising the occurrence of unsightly salts, which can manifest on any brickwork given certain conditions.

Efflorescence and Vanadium staining is most prevalent in the early life of the building, particularly the first year, but often recurring during the second and perhaps third year, although generally to a lesser degree. It commonly occurs in spring, following wet winter working conditions, when the building dries out for the first time.

Apart from the salts derived from the bricks and mortar, almost any soluble salt can form efflorescence if it is introduced as a contamination from external sources. The quantities of salts involved are small and a tiny percentage of soluble sulphates in the bricks or the Portland cement, is sufficient to account for the amount of efflorescence often seen. Coastal areas may also be prone to efflorescence from sea salt being blown inland.

- Bricks should be stacked onto a clean, firm, level surface. They should be protected from rain, mud splashes, etc. by covering with waterproof covers.
- Turn over the scaffolding boards closest to the brickwork at all interruptions to construction.
- Newly erected masonry should be covered to protect cavities and stop masonry becoming saturated.
- Unless instructed otherwise, wetting of bricks prior to laying should be avoided.
- Connect rain-water down-pipes as soon as possible as prolonged saturation will result with efflorescence or staining as the inevitable consequence.
- Equally important is the incorporation of the appropriate d.p.c.'s, copings and cills at the design stage. No amount of good site management can alleviate efflorescence arising from saturation due to a badly designed construction.

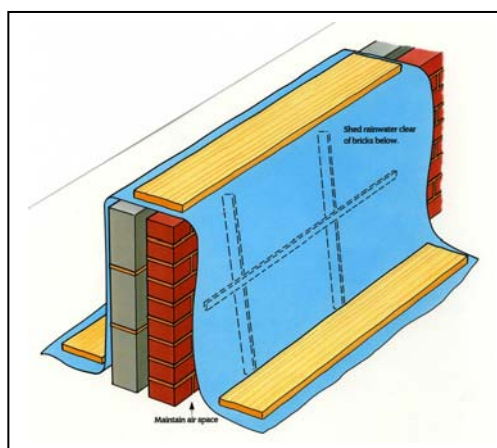

Many of the above precautions will also greatly help in the reduction of **iron staining** and '**peacocking**' with Blue facing bricks.

For further help or advice contact the **Ibstock Technical Services Helpline** on 0870 903 4017 or the **Design Advice Helpline** on 0870 903 4018.

Issue 1 December 2004